

Mould Tool Clamps Data Sheet

Dowel Set



Part Number: XA-0303

Heavy duty machined steel clamp dowel location set for RTM tooling.

This set features a shimmed male cone, allowing 'Z' stop adjustment.

Designed to be welded directly to a mould tool frame structure.

Mould Clamp Complete Set



Part Number: XA-0300

Heavy duty machined clamp dowel location set for RTM tooling. This set features a shimmed male cone as well as an M24 bolt, allowing 'Z' stop adjustment.

Designed to be welded directly to a mould tool frame structure.

Toggle Clamp



Part Number: XA-0301

Fast action, heavy duty toggle clamp system.

Designed to fit mould tool clamp complete set (XA-0300).

Complete Dowel and Toggle Assembly

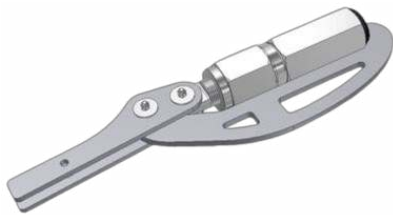

Part Number: XA-0314

Complete assembly including all of the following parts:

XA-0303
XA-0300
XA-0301

Designed for use with RTM moulds.

Latch Clamp—2200N



Part Number: RD-35-0001

A medium duty latch clamp suitable to be used for VRTM tooling.

Complete with bracket to suit 2200N clamp (RD-35-0105).

Latch Clamp—3400N



Part Number: RD-35-0003

A heavy duty latch clamp suitable to be used for VRTM tooling.

Complete with bracket to suit 3400N clamp (RD-35-0104).

How to order:

To specify a product, please use the appropriate part number and indicate the quantity. Please contact Composite Integration using any of the contact information featured below.



+44 (0)1752 849 998

Info@composite-integration.co.uk

www.composite-integration.co.uk

DS-0017-C Issued: 28.11.2022